

Oceanis 46.1 - 4 cab. - 2020.

Marina Šangulin, Biograd

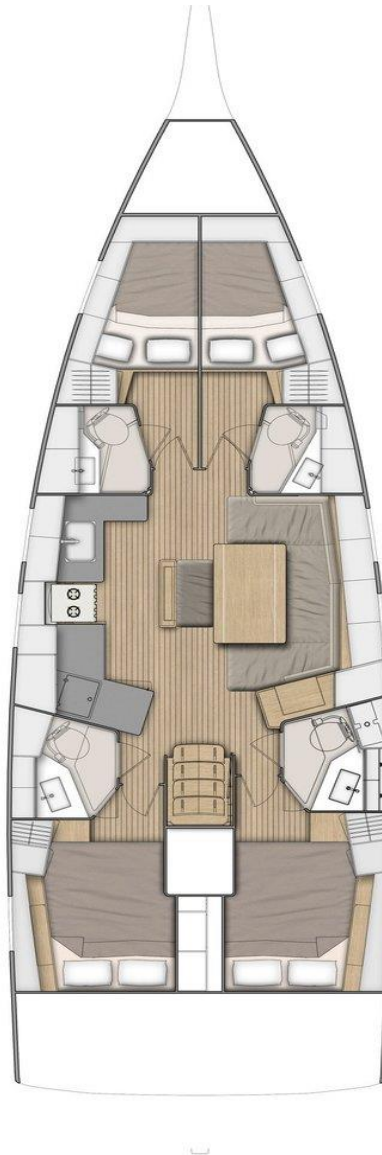

Technical Details

Type:	Sailing yacht
Producer:	Bénéteau
Build year:	2020.
Length overall:	14.6 m
Beam:	4.5 m
Draft:	2.35 m
Cabins:	4
Berths:	8 + 2
Toilets:	4
Max. passengers:	registered for 10

Main sail:	furling/roll
Genoa:	furling/roll
Steering type:	2 Steering Wheels
Engine:	1 x 57.0 HP
Engine builder:	Yanmar
Water tank:	570 l
Fuel tank:	200 l

Standard Equipment

Sails:

2 x Winch

Navigation:

Autopilot
- *Raymarine P70S*

Binoculars

Bow thruster

Compass

Divider, nautic chart

GPS chart plotter - cockpit
- *Raymarine Axiom 7"*

Navigation (Nautical) charts and nautical guide

Navigation set

Radar reflector

Tridata
- *Raymarine pack*

Wind instrument/Anemometer
- *Raymarine pack*

Safety:

Distress flare box

Emergency tiller

Fire extinguisher

First aid kit

Fog horn

10 x Life belts (Safety harness)

Life buoy + Flashing light

10 x Life jackets

Liferaft

VHF radio
- *Raymarine53 , AIS*

Yacht electrics:

220 volt socket

Battery charger

Bilge pump - Electric

Heating

Service batteries

- 3 x 100 Ah + 1x40 Ah

Shore connection 220 V

Shore power cable

Water heater

Deck:

Anchor Delta

- 20 kg

Anchor Jambo

- 10 kg

Bathing platform

Bimini top

Black Water Tank

Boat hook

Cockpit cushions

Cockpit table

Cockpit/stern, outside shower

Dinghy

- 2,40m

Electric anchor windlass

9 x Fenders

- 8 + 1

Gangway

Main anchor

Mooring ropes

Sprayhood

Teak cockpit

Winch handles

Galley:

2 x Gas bottles

Gas cookers

Kitchen utensils (Galley equipment, cutlery)

Oven

- gas

Refrigerator

- with top opening and icebox

Interior:

Barometer

Bilge pump - mechanic

Clock

Electric fans in cabins

Hand-held compass

Entertainment :

Cockpit grill

Fusion radio

2 x Outside speakers

Wi-Fi Internet

Other:

Flashlight

Mosquito nets

Pump

Repair kit

Set of tools

Teak seats in cockpit

